



**STONE WORKS**  
by



[www.oakspavers.com](http://www.oakspavers.com)

# GARDENIA

## Benefits

- units are pre-split for fast and easy construction
- unique double-wing design allows for straight or curved wall designs
- remove one wing for gentle sweeping curves, or both wings for tighter curves
- light weight, hollow core units ideal for constructing planter walls, tree surrounds and garden edging

## Dimensions



**Standard Unit**  
Width 200 mm (7.87")  
Height 150 mm (5.91")



**90° Corner Unit**  
Width 300 mm (11.81")  
Height 150 mm (5.91")



**Coping Unit**  
Width 615 mm (24.21")  
Height 75 mm (2.95")  
Depth 220 mm (8.66")



**Step Tread**  
Width 615 mm (24.21")  
Height 75 mm (2.95")  
Depth 315 mm (12.40")

## Packaging Specifications

Gardenia	Square face ft/ bundle	Linear ft/bundle	Pieces/ bundle	Linear ft/ piece	Square face ft/ piece	Pieces/ square face ft	Weight/bundle		Weight/piece	
							(lbs.)	(kg)	(lbs.)	(kg)
Standard Unit	38.8	78.7	120	.67	.33	3	2580	1170	21.5	9.75
90° Corner Unit	18	12 vertical	24	1	.81	1.2	1080	490	45	20.42
2' Coping Unit	12	48	24	2	.50	2	1272	577	53	24.05
2' Step Tread	12	48	24	2	.50	2	1850	838	77	34.93

### Create tapered Gardenia Units

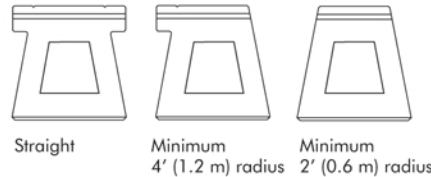

### Gardenia - 90° Corner

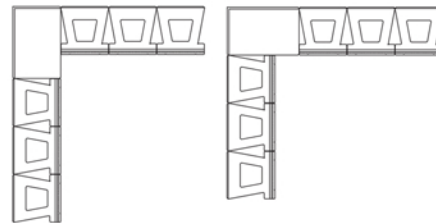

### Gardenia - Outside Curve

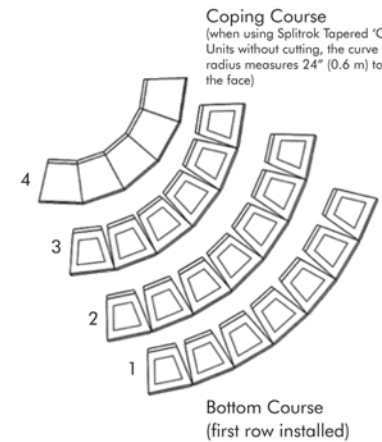

### Cross Section

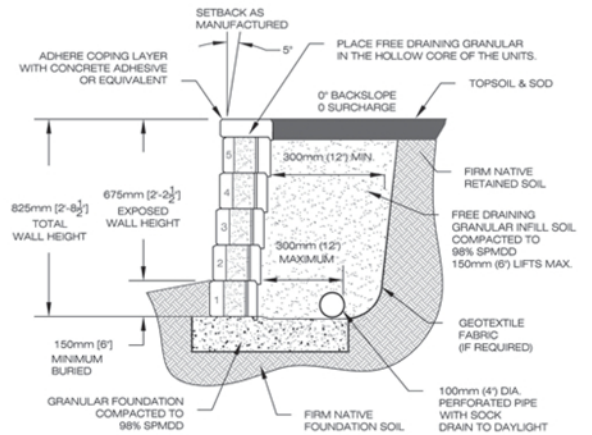

Any walls exceeding the recommended building heights will require engineering, please contact an Oaks sales representative.



Brampton Brick Limited  
225 Wanless Drive  
Brampton, ON, L7A 1E9  
c.o.b.

OAKS CONCRETE PRODUCTS

Central Order Desk:  
1-800-709-OAKS (6257)

**Brampton**  
Petworth Road  
west of Hurontario Street  
Brampton, Ontario  
Phone: (905) 840-1011 ext.3405  
Fax: (905) 846-7119

**Markham**  
455 Rodick Road  
Markham, Ontario  
L6G 1B2  
Phone: (905) 475-5900  
Fax: (905) 479-2894

**Milton**  
475 Harrop Drive  
Milton, Ontario  
L9T 3H3  
Phone: (905) 875-0035  
Fax: (905) 878-5301

**Detroit**  
51744 Pontiac Trail  
Wixom, Michigan  
48393  
Phone: (248) 684-5004  
Fax: (248) 684-2726

**Chicago**  
1900 Vulcan Boulevard  
Bartlett, Illinois  
60103  
Phone: (847) 488-1100  
Fax: (847) 488-1101